

DETAIL 5. TERRAZZO CONTROL JOINTING OVER FULL ELASTOMERIC MEMBRANE

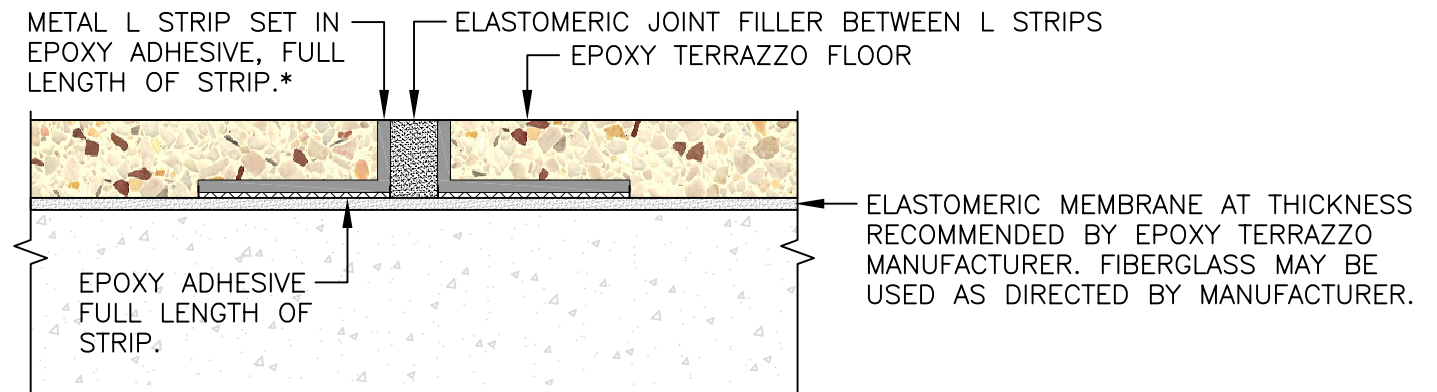

SCALE: FULL SCALE

04/09

THE USE OF DIVIDER STRIPS (L STRIPS) SHOULD BE CONSIDERED IN AREAS WHERE FLOOR TEMPERATURE CHANGES MAY OCCUR. SUCH AS GLASS WALLS AND OR SKY LIGHTS, IF JOINTS ARE TO BE USED, THE DESIGN TEAMS MUST DETERMINE SPACING. SPACING NOT TO EXCEED 30 FEET.